

# Absortop Installation Guide



Take out the blue Absortop unit from its transparent plastic packaging. This activates the Absortop.

Take out the four gray attachment parts which include: the **cup nut**, the **hook bar**, the **threaded rod** and the **main bracket**.



Take the threaded rod and place it in the main bracket.



Slide the hook through the main bracket and the threaded rod.

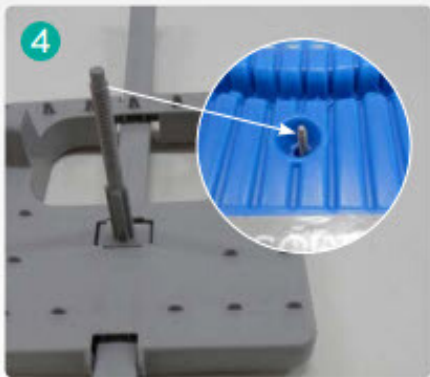

Place the blue Absortop unit on the main bracket. You should see the top of the threaded rod through the blue Absortop unit.



Lightly tighten the cup nut by turning it in a clock wise direction. It should be tightened fully later in step 8.



Hang the Absortop on lashing ring and press the hook downwards until it clicks.



Push blue Absortop unit upwards, all the way up to the ceiling.



Tighten the cup nut firmly.

